



Park View Court | Windsor





- Ground floor maisonette
- Converted three years ago
- Two double bedrooms
- Modern fitted kitchen
- Contemporary bathroom
- No onward chain
- Allocated parking
- Tucked away location



## Park View Court | Windsor

A very well presented two bedroom maisonette located in a tucked away private location on St Leonards Road within approximately 15/20 minutes walking distance of the town. The property was converted approximately three years ago and features two double bedrooms, modern fitted kitchen, contemporary bathroom and allocated parking.

# Park View Court | Windsor

APPROX. GROSS INTERNAL FLOOR AREA 479 SQ FT / 45 SQ M

Floorplans are for identification and guideline purposes only, not to scale.

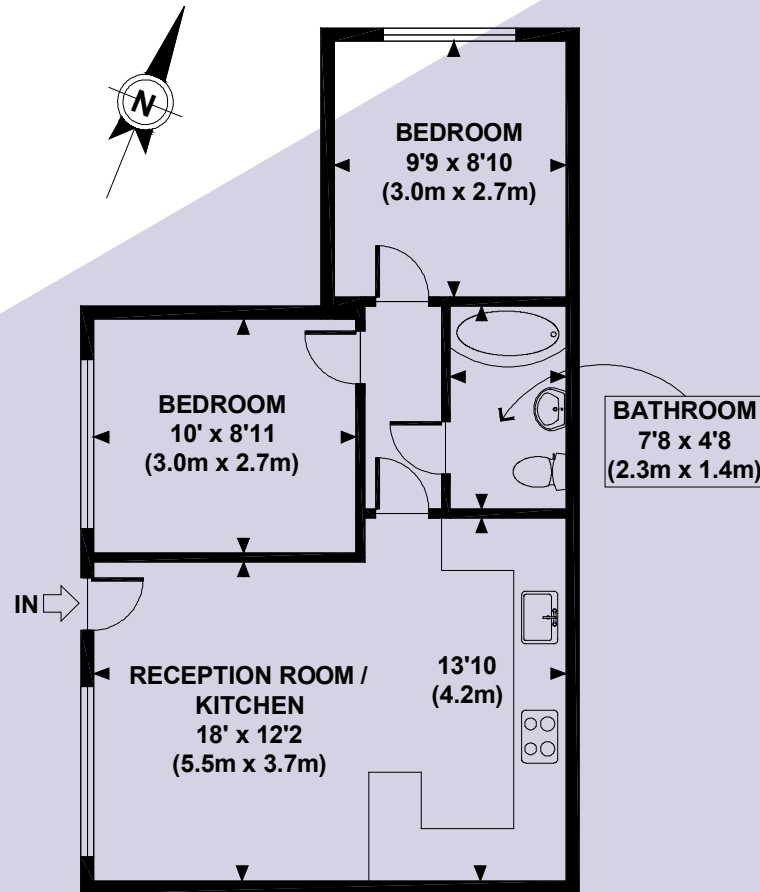

**GROUND FLOOR  
GROSS INTERNAL  
FLOOR AREA 479 SQ FT**



## VIEWING:

Strictly by appointment with Elite Property. Prior to making an appointment to view, we strongly recommend that you discuss any particular points, which are likely to affect your interest in the property with a member of staff who has seen the property in order that you do not make a wasted journey.

## MISREPRESENTATION ACT:

The particulars in this brochure have been produced in good faith, are set out as a general guide and do not constitute the whole or part of any contract. All liability in negligence or otherwise, arising from the use of the particulars is hereby excluded.

53 St Leonards Road  
Windsor  
SL4 3BX

Phone 01753 855 766  
info@elite-property.co.uk  
www.elite-property.co.uk